

Installation Instructions

Kia Sportage (2016+)



Step

Instructions

1

Remove the lower right plastic trim piece under steering wheel



2

Remove left side piece & middle panel (Be careful not to bend this part)



3 Remove the front console and unplug all wires from the back



4 Screw in side bracket to front console

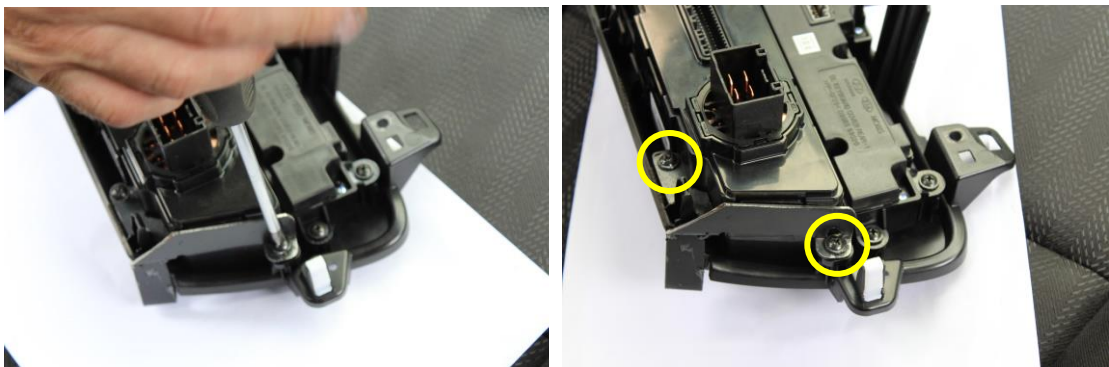

5 Reinstall centre console and screw in bracket



- 6 Reinstall all panels (middle, side left and lower right panels)



- 7 Install front dash bracket with 3x countersunk M5 screws provided



- 8 Enjoy your new In Dash Mount!



If you have any issues or questions, please contact us.
Industrial Evolution