

Installation Instructions Hyundai Tucson (2021+)



Step

Instructions

- 1** Loosen side panel from display unit. Remove 2 x screws. Repeat for opposite side panel



- 2** Loosen panel on underside of display unit. Then release unit from the dash and unplug cables.



- 3** On the rear of the display unit remove 6 x screws. Install first bracket using these 6 x points. (2 x small screws provided)

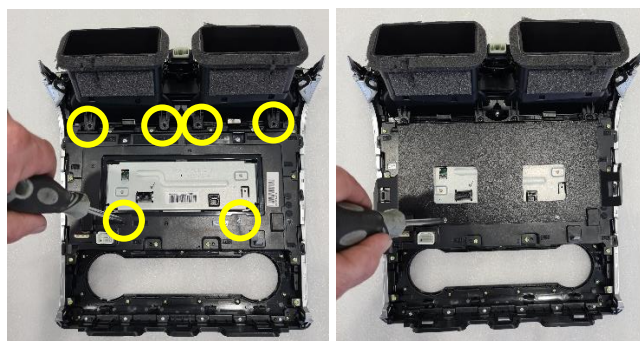

- 4 Using a sharp blade, carefully cut out a small part of the internal dash plastic as shown.



- 5 Remove 1 x screw from dash, then install second bracket as shown.

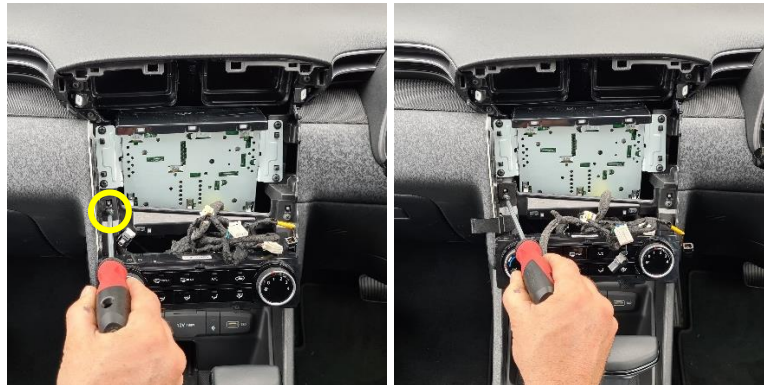

- 6 Return cables, then reinstall display unit, 4 x screws, and underside panel.



- 7 Set side panel in place and mark the section that touches the installed bracket. Then, using a sharp blade shave this internal section away and install panel.



8

Repeat for opposite side panel.



9

Install dash bracket with 3 x screws provided.

Enjoy your new InDash Mount



If you have any issues or questions, please contact us.