

Installation Instructions

Ford Everest (2022+)

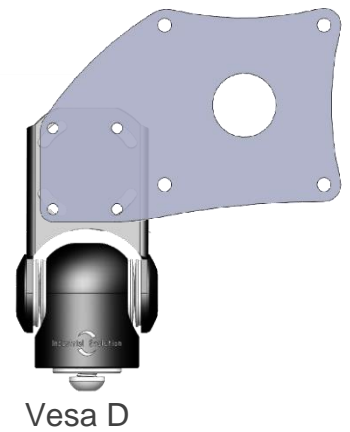

STEP	INSTRUCTION
------	-------------

1

Loosen and set aside left and right side lower console pieces.
 Then loosen and angle the gear stick surround as shown.



- 2 Remove 3 x indicated screws from the lower centre console. Then remove 1 x screw from both the left and right sides of lower console.



- 3 Loosen and set aside the internal dash tray, then remove indicated plastic part and store away.



- 4 Install left and right-side brackets as shown using 1 x previously removed screw and 2 x supplied self tapper screws each. Return left and right-side lower console pieces to their original state.



- 5** Install lower bracket place. Using a sharp blade, carefully shave the indicated plastic from the previously removed internal dash tray. This is the area of contact between the lower bracket and the dash tray.



- 6** Return dash tray, 3 x indicated screws, and gear stick surround to their original state.



- 7** Install front bracket using 4x countersunk screws provided.



Enjoy your new InDash Mount!

If you have any issues or questions, please contact us.